

DIRECTIONS

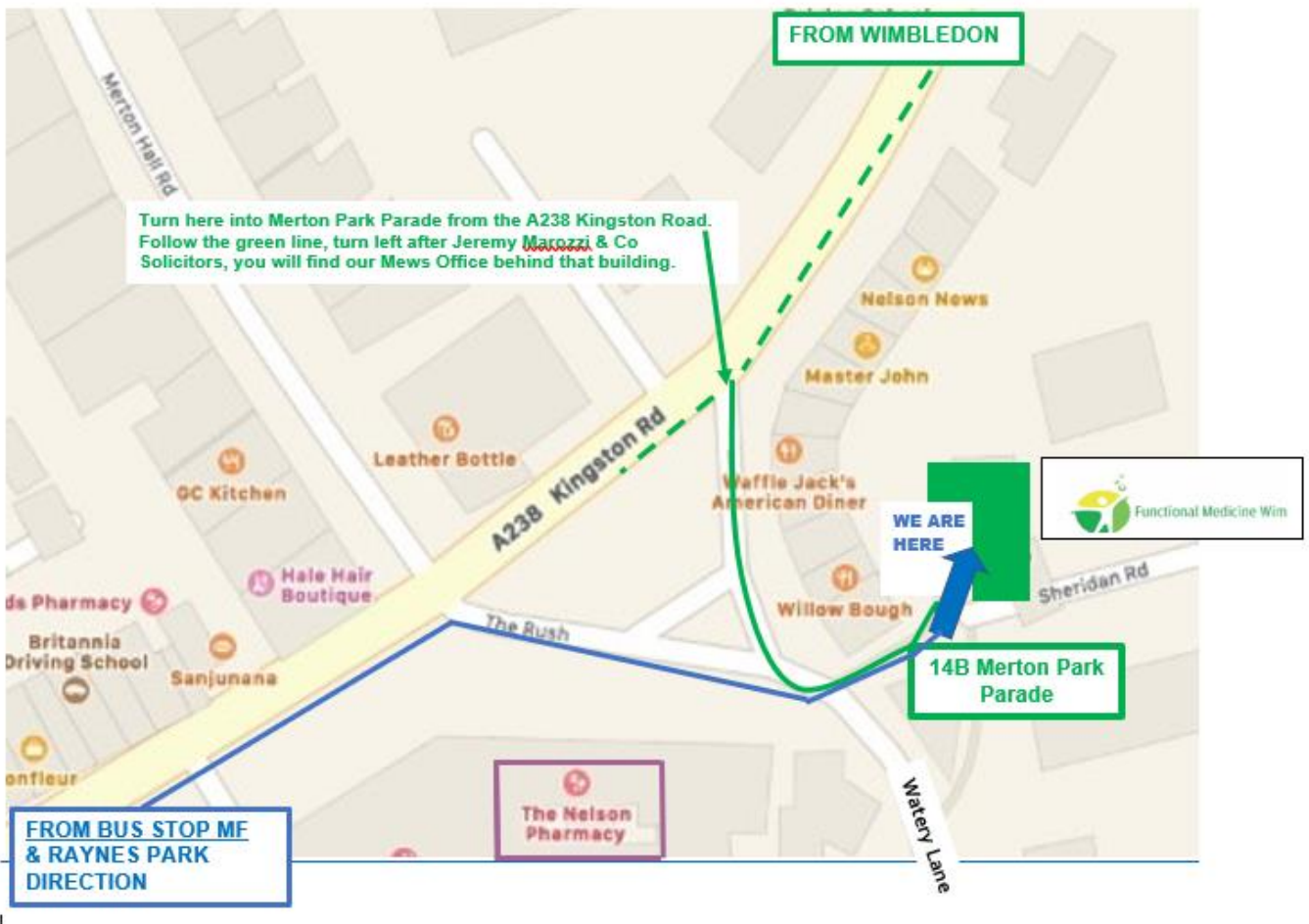

PARKING:

- Metered parking is available in front of the shops at Merton Park Parade on the Kingston Road and Watery Lane (pay & display from 10am-4pm)
- Other metered parking is available in the surrounding roads:
 - Sheridan Road (a small alleyway leads from Sheridan Road to Watery Lane close to the clinic)
 - Various roads that run off Kingston Road have metered parking e.g. Merton Hall Road, Quintin Avenue, Richmond Avenue, Mostyn Road (also has an alleyway leading to Watery lane if you park near the bowls club).

WIMBLEDON TRANSPORT LINKS:

TRAIN & BUS FROM WIMBLEDON

Arrive at Wimbledon Train/Tube station:

- Walk for less than 1 minute to Wimbledon (Stop D) Bus Stop
- From there you can catch either the **163 bus or the 164 bus** (towards Morden) – these buses run every 9 minutes and take approx 8 minutes to reach (Stop MF) The Nelson Health Centre Bus Stop (opposite Quintin Avenue)
- It is then a very short walk to Merton Park Parade
- Walk back along the main road A238 Kingston Road
- Turn right onto The Rush (opposite (Merton Hall Rd)
- You will reach Nelson Pharmacy (on your right), cross the road and continue into the small road/driveway between Jeremy Marozzi Solicitors (on left side of the road) and a currently empty building (on right side of the driveway)
- As you continue up the small road/driveway you will see on a fence in front of you a Private Parking Sign for Functional Medicine Wimbledon; the clinic is to the left of this.

TRAIN & WALK FROM WIMBLEDON

Arrive at Wimbledon Train/Tube station

- Catch a Thameslink Train (towards Sutton) to Wimbledon Chase
- Exit station and walk for approximately 7 minutes
- Start on Rothesay Avenue – walk for 10 yards
- Turn left onto the main road A238 Kingston Road – walk for 20 yards
- Turn right onto The Rush (opposite (Merton Hall Rd)
- You will reach Nelson Pharmacy (on your right), cross the road and continue into the small road/driveway between Jeremy Marozzi Solicitors (on left side of the road) and a currently empty building (on right side of the driveway)
- As you continue up the small road/driveway you will see on a fence in front of you a Private Parking Sign for Functional Medicine Wimbledon; the clinic is to the left of this.

TRAM & WALK

Arrive at Wimbledon Train/Tube Station

- Get on a Wimbledon Tramlink (towards Elmer's End or Beckenham Junction) – they run every 5 mins and it is a 3 min journey
- Exit tram at Merton Park station
- Turn left and walk to A238 Kingston Road
- Walk for approx. 80 yards
- Turn left on to The Rush and Merton Park Parade (just past Waffle Jack's Diner)
- Turn left into the small road/driveway between Jeremy Marozzi Solicitors and a currently empty building (on right side of the driveway)
- As you continue up the small road/driveway you will see on a fence in front of you a Private Parking Sign for Functional Medicine Wimbledon; the clinic is to the left of this.

WIMBLEDON LOCAL TAXI SERVICES

Raynes Park Cars Tel: 0208 540 9999 Email: info@raynesparkcars.co.uk www.raynesparkcars.co.uk
online/app booking availability

Merton Mini Cabs Tel: 0208 540 4444 Email: info@mertonminicabs.london www.mertonminicabs.london
online booking availability

Elite Car Service Tel: 0208 944 7000 Email: bookings@elitecarservice.com www.elitecarservice.com
online/app booking availability

UBER TAXIS VIA THE APP